

CPU HOLDER (CPU-1020)

Dimensions:

20" high, 15" deep, adjustable width.

Configuration:

Mounts to underside of work-surface and to an adjacent base cabinet

Material:

100% Steel

Standard Finish:

Any of our Powder Coat Colors

Optional Finish:

Stainless Steel

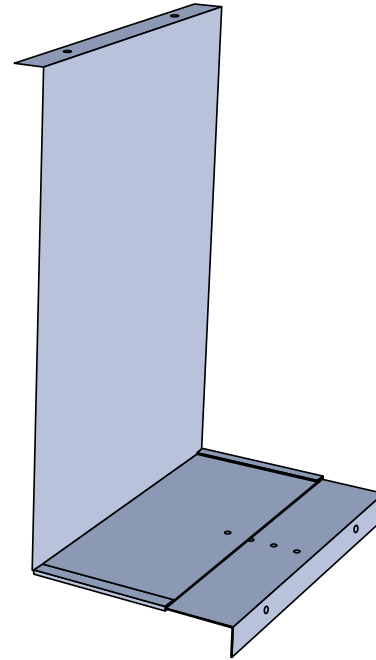

CPU HOLDER (CPU-1020-M)

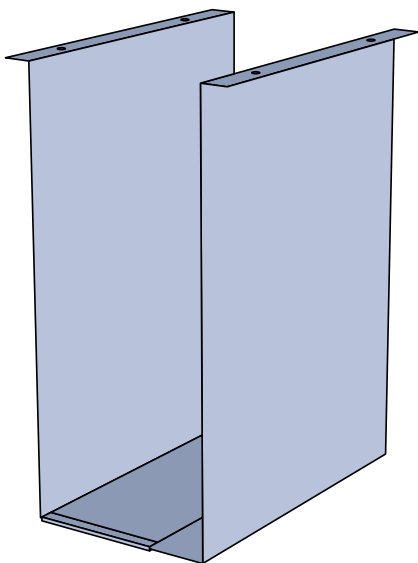

Dimensions:

20" high, 15" deep, adjustable width

Configuration:

Mounts to underside of work-surface

Material:

100% Steel

Standard Finish:

Any of our Powder Coat Colors

Optional Finish:

Stainless Steel