

ISLAND SINK CABINET WL-7001-I

Teclab builds modular cabinetry of superior strength, thanks to twin full-perimeter frames. We also set door and drawer faces into the cabinet shell to protect the contents from spills.

WL-7001 FEATURES

One "B" panel, two "C" door base cabinet.

Cabinet Dimensions: 70" wide, 35 1/2" high, 22" deep

NOTE:

Island Cabinets are also available with standard full-width bases for use when not positioned at the end of an island.

"B" Panel

Dimensions: 68 3/8" wide, 6 1/16" high, 1" thick.

Center Panel

Dimensions: 23 3/8" wide, 20 3/8" high, 1" thick.

"C" Door

Door Face Dimensions: 22 3/8" wide, 20 3/8" high, 1" thick.



TOP



FRONT

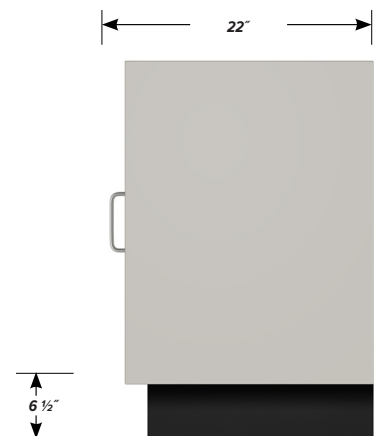

SIDE