

## ISLAND SINK CABINET WL-6101-I

Teclab builds modular cabinetry of superior strength, thanks to twin full-perimeter frames. We also set door and drawer faces into the cabinet shell to protect the contents from spills.

### WL-6101 FEATURES

**One "B" panel, two "C" door base cabinet.**

Cabinet Dimensions: 61" wide, 35 1/2" high, 22" deep

**NOTE:**

Island Cabinets are also available with standard full-width bases for use when not positioned at the end of an island.

**"B" Panel**

Dimensions: 59 3/8" wide, 6 1/16" high, 1" thick.

**Center Panel**

Dimensions: 14 3/8" wide, 20 3/8" high, 1" thick.

**"C" Door**

Door Face Dimensions: 22 3/8" wide, 20 3/8" high, 1" thick.



**TOP**



**FRONT**

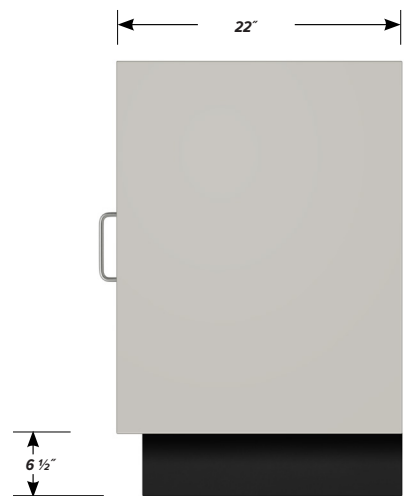

**SIDE**