

BENCH HIGH BASE CABINET WL-4852R

Teclab builds modular cabinetry of superior strength, thanks to twin full-perimeter frames. We also set door and drawer faces into the cabinet shell to protect the contents from spills.



WL-4852R FEATURES

One "D" door, one "D" panel base cabinet.

Cabinet Dimensions: 48" wide, 35 1/2" high, 22" deep

"D" Door

Door Face Dimensions: 23 1/4" w, 27 3/16" h, 1" thick.

"D" Panel

Panel Dimensions: 23 1/4" w, 27 3/16" h, 1" thick.



TOP



FRONT

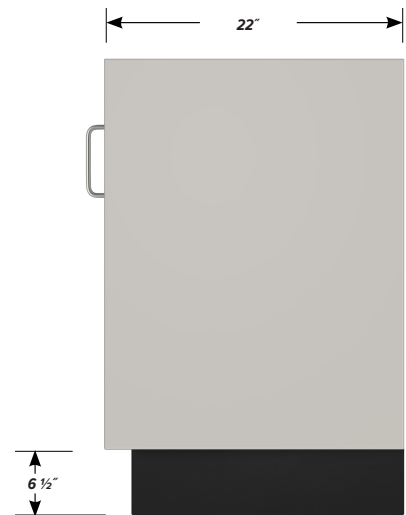

SIDE