

## BENCH HIGH BASE CABINET WL-4830

Teclab builds modular cabinetry of superior strength, thanks to twin full-perimeter frames. We also set door and drawer faces into the cabinet shell to protect the contents from spills.



### WL-4830 FEATURES

**One full width "B" drawer, two half width "A" drawer, three half width "B" drawer, one half width "C" drawer base cabinet.**

Cabinet Dimensions: 48" wide, 35 1/2" high, 22" deep

#### "B" Drawer (full width)

Dwr. Face Dimensions: 46 3/8" wide, 6 11/16" high, 1" thick.  
 Drawer Body Inside Dims.: 43 7/8" w, 5" h, 19 1/2" deep.  
 Weight Capacity: 75 lbs.

#### "A" Drawer (half width)

Drawer Face Dimensions: 22 3/8" wide, 3 1/4" high, 1" thick.  
 Dwr. Body Inside Dims.: 19 7/8" wide, 2" high, 19 1/2" deep.  
 Weight Capacity: 75 lbs.

#### "B" Drawer (half width)

Dr. Face Dimensions: 22 3/8" wide, 6 11/16" high, 1" thick.  
 Dwr. Body Inside Dims.: 19 7/8" wide, 5" high, 19 1/2" deep.  
 Weight Capacity: 75 lbs.

#### "C" Drawer (half width)

Dwr. Face Dimensions: 22 3/8" wide, 13 1/2" high, 1" thick.  
 Dwr. Body Inside Dims.: 19 7/8" w, 9 1/2" h, 19 1/2" deep.  
 Weight Capacity: 75 lbs.

*All "C" drawers accept standard hanging files with the addition of our Hanging File Adapter Kit.*



**TOP**

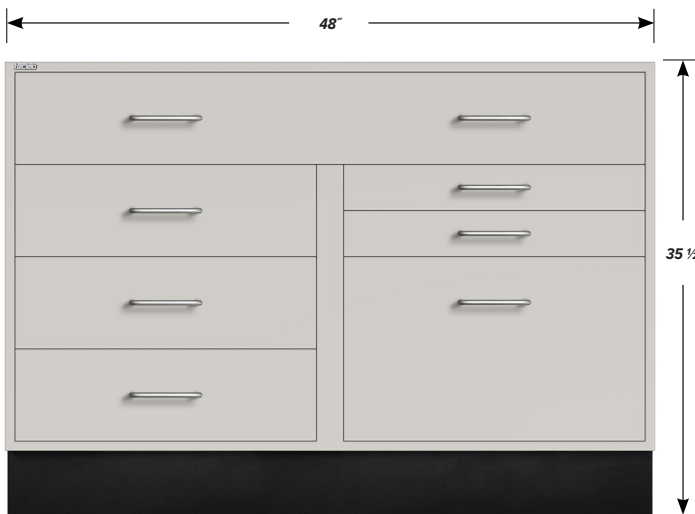

**FRONT**



**SIDE**