

BENCH HIGH BASE CABINET WL-4824

Teclab builds modular cabinetry of superior strength, thanks to twin full-perimeter frames. We also set door and drawer faces into the cabinet shell to protect the contents from spills.



WL-4824 FEATURES

One full width "B" drawer, four half width "B" drawer, one half width "C" drawer base cabinet.

Cabinet Dimensions: 48" wide, 35 1/2" high, 22" deep

"B" Drawer (full width)

Drawer Face Dimensions: 46 3/8" w, 6 1 1/16" h, 1" thick.
 Drawer Body Inside Dims.: 43 7/8" w, 5" h, 19 1/2" deep.
 Weight Capacity: 75 lbs.

"B" Drawer (half width)

Drawer Face Dimensions: 22 3/8" w, 6 1 1/16" h, 1" thick.
 Drawer Body Inside Dims.: 19 7/8" w, 5" h, 19 1/2" deep.
 Weight Capacity: 75 lbs.

"C" Drawer (half width)

Drawer Face Dimensions: 22 3/8" w, 13 1/2" h, 1" thick.
 Drawer Body Inside Dims.: 19 7/8" w, 9 1/2" h, 19 1/2" deep.
 Weight Capacity: 75 lbs.

All "C" drawers accept standard hanging files with the addition of our Hanging File Adapter Kit.



TOP

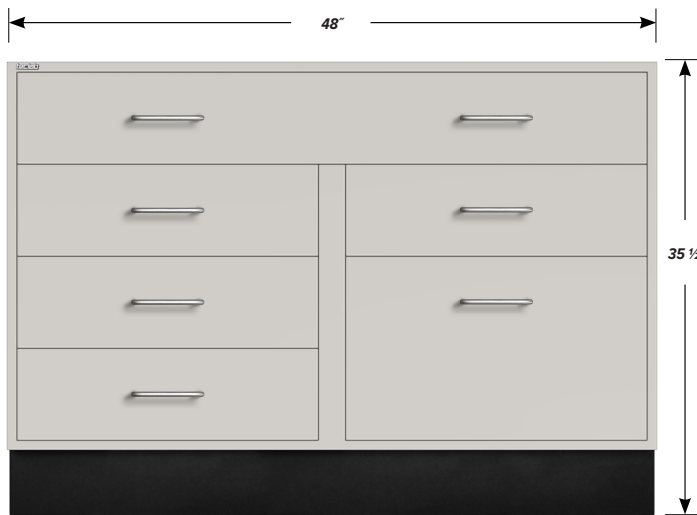

FRONT



SIDE