

**BENCH HIGH BASE CABINET WL-4209**

Teclab builds modular cabinetry of superior strength, thanks to twin full-perimeter frames. We also set door and drawer faces into the cabinet shell to protect the contents from spills.



**WL-4209 FEATURES**

**Two half width "B" drawer, two "C" door base cabinet.**

Cabinet Dimensions: 42" wide, 35 1/2" high, 22" deep

**"B" Drawer (half width)**

Drawer Face Dimensions: 19 3/8" wide, 6 1 1/16" high, 1" thick.  
 Drawer Body Inside Dimensions: 16 7/8" w, 5" h, 19 1/2" deep.  
 Weight Capacity: 75 lbs.

**"C" Door**

Door Face Dimensions: 20 1/4" wide, 20 3/8" high, 1" thick.

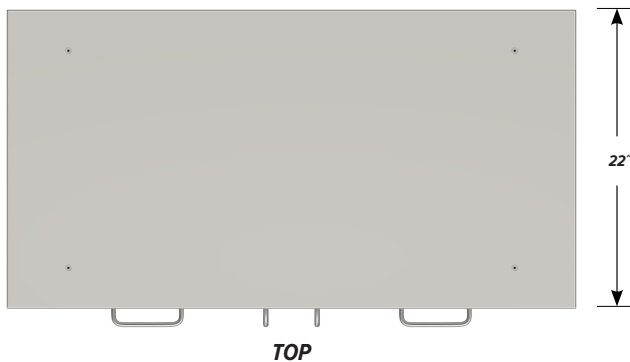

**TOP**



**FRONT**

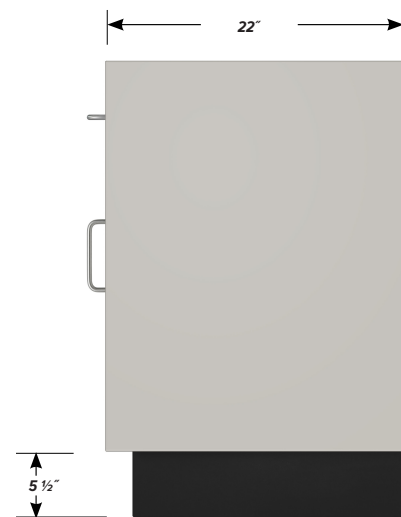

**SIDE**