

BENCH HIGH BASE CABINET WL-3652

Teclab builds modular cabinetry of superior strength, thanks to twin full-perimeter frames. We also set door and drawer faces into the cabinet shell to protect the contents from spills.



WL-3652 FEATURES

One full width "B" drawer, six half width "A" drawer, one "C" door base cabinet.

Cabinet Dimensions: 36" wide, 35 1/2" high, 22" deep

"B" Drawer (full width)

Drawer Face Dimensions: 34 3/8" w, 6 1/16" h, 1" thick.
 Drawer Body Inside Dims.: 31 7/8" w, 5" h, 19 1/2" deep.
 Weight Capacity: 75 lbs.

"A" Drawer (half width)

Drawer Face Dimensions: 16 3/8" wide, 3 1/4" high, 1" thick.
 Drawer Body Inside Dims.: 13 7/8" w, 2" h, 19 1/2" deep.
 Weight Capacity: 75 lbs.

"C" Door with Left Hand Pull

Door Face Dimensions: 16 3/8" wide, 20 7/16" high, 1" thick.

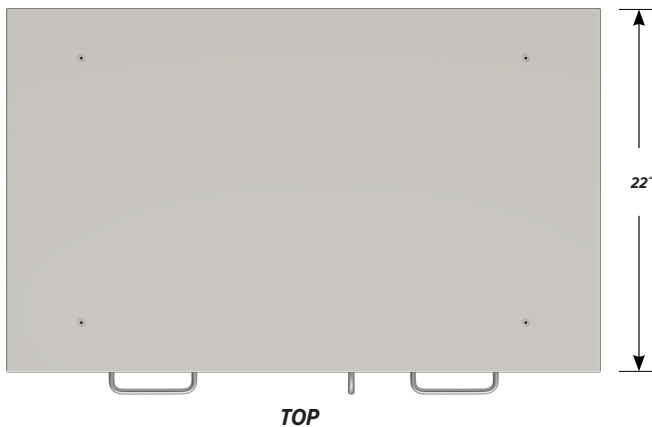

TOP



FRONT

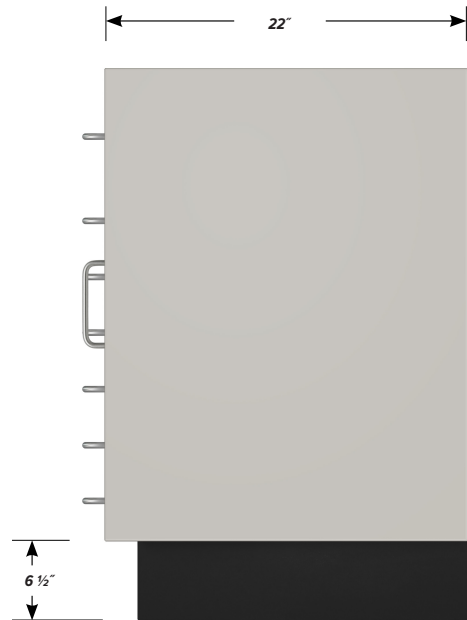

SIDE