

BENCH HIGH BASE CABINET WL-3632

Teclab builds modular cabinetry of superior strength, thanks to twin full-perimeter frames. We also set door and drawer faces into the cabinet shell to protect the contents from spills.

Any Base Cabinet can be made **MOBILE**.



WL-3632 FEATURES

One full width "B" drawer, two half width "A" drawer, five half width "B" drawer base cabinet.

Cabinet Dimensions: 36" wide, 35 1/2" high, 22" deep

"B" Drawer (full width)

Drawer Face Dimensions: 34 3/8" w, 6 11/16" h, 1" thick.
Drawer Body Inside Dims.: 31 7/8" w, 5" h, 19 1/2" deep.
Weight Capacity: 75 lbs.

"A" Drawer (half width)

Drawer Face Dimensions: 16 3/8" wide, 3 1/4" high, 1" thick.
Drawer Body Inside Dims.: 13 7/8" w, 2" h, 19 1/2" deep.
Weight Capacity: 75 lbs.

"B" Drawer (half width)

Drawer Face Dimensions: 16 3/8" w, 6 11/16" h, 1" thick.
Drawer Body Inside Dims.: 13 7/8" w, 5" h, 19 1/2" deep.
Weight Capacity: 75 lbs.



TOP



FRONT

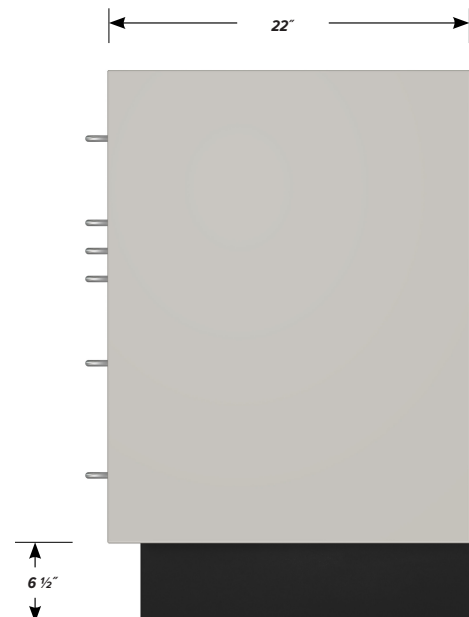

SIDE