

BENCH HIGH BASE CABINET WL-3609

Teclab builds modular cabinetry of superior strength, thanks to twin full-perimeter frames. We also set door and drawer faces into the cabinet shell to protect the contents from spills.



WL-3609 FEATURES

Two half width "B" drawer, two "C" door base cabinet.

Cabinet Dimensions: 36" wide, 35 1/2" high, 22" deep

"B" Drawer (half width)

Drawer Face Dimensions: 16 3/8" w, 6 1/16" h, 1" thick.
 Drawer Body Inside Dims.: 13 7/8" w, 5" h, 19 1/2" deep.
 Weight Capacity: 75 lbs.

"C" Door

Door Face Dimensions: 17 1/4" wide, 20 3/8" high, 1" thick.

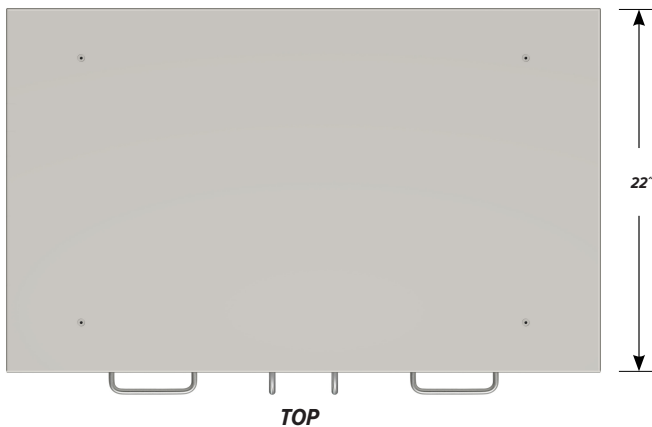

TOP



FRONT

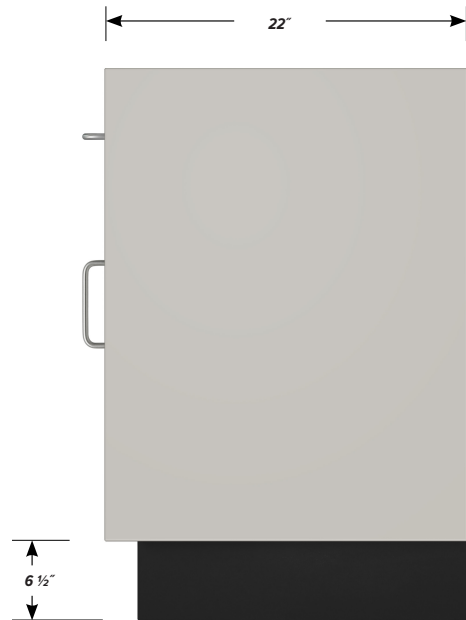

SIDE