

BENCH HIGH BASE CABINET WL-3014

Teclab builds modular cabinetry of superior strength, thanks to twin full-perimeter frames. We also set door and drawer faces into the cabinet shell to protect the contents from spills.



WL-3014 FEATURES

Two "A" drawer, one "B" drawer, one "C" drawer base cabinet.

Cabinet Dimensions: 30" wide, 35 1/2" high, 22" deep

"A" Drawer

Drawer Face Dimensions: 28 3/8" wide, 3 1/4" high, 1" thick.
 Drawer Body Inside Dimensions: 25 7/8" wide, 2" high, 20" deep.
 Weight Capacity: 75 lbs.

"B" Drawer

Drawer Face Dimensions: 28 3/8" wide, 6 1/16" high, 1" thick.
 Drawer Body Inside Dimensions: 25 7/8" w, 5" h, 19 1/2" deep.
 Weight Capacity: 75 lbs.

"C" Drawer

Drawer Face Dimensions: 28 3/8" wide, 13 1/2" high, 1" thick.
 Drawer Body Inside Dimensions: 25 7/8" w, 9 1/2" h, 19 1/2" deep.
 Weight Capacity: 75 lbs.

All "C" drawers accept standard hanging files with the addition of our Hanging File Adapter Kit.



FRONT

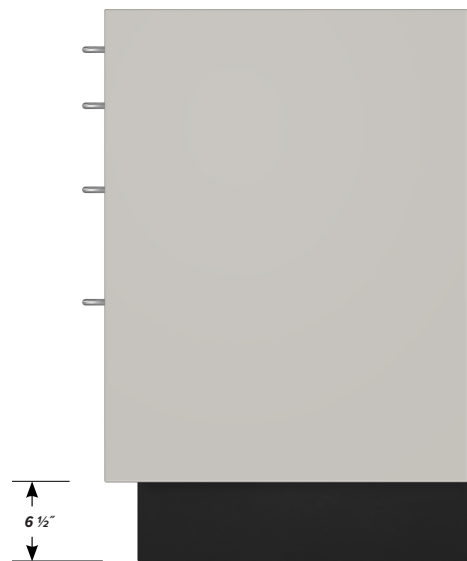

SIDE