

**BENCH HIGH BASE CABINET WL-2414**

Teclab builds modular cabinetry of superior strength, thanks to twin full-perimeter frames. We also set door and drawer faces into the cabinet shell to protect the contents from spills.



**WL-2414 FEATURES**

**Three "A" drawer, one "B" door with LH pull base cabinet.**

Cabinet Dimensions: 24" wide, 35 1/2" high, 22" deep

**"A" Drawer**

Drawer Face Dimensions: 22 3/8" wide, 3 1/4" high, 1" thick.  
 Drawer Body Inside Dimensions: 19 7/8" w, 2" h, 20" deep.  
 Weight Capacity: 75 lbs.

*All "C" drawers accept standard hanging files with the addition of our Hanging File Adapter Kit.*

**"B" Door with Left Hand Pull**

Door Face Dimensions: 22 3/8" wide, 16 15/16" high, 1" thick

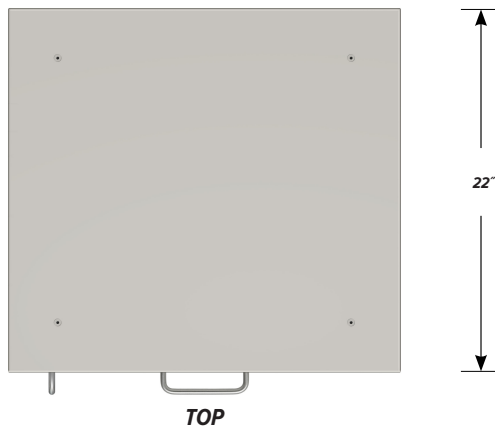

**FRONT**

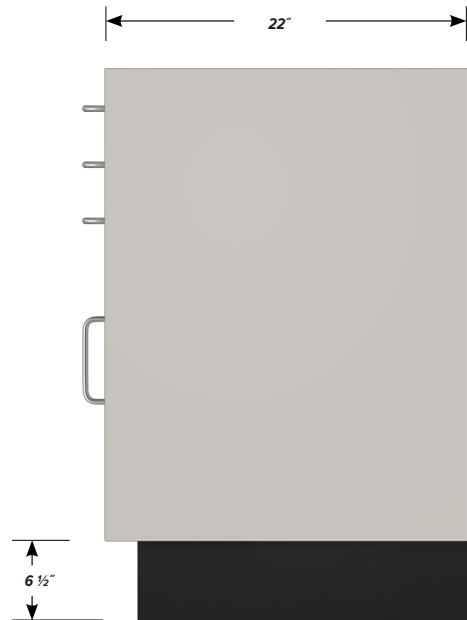

**SIDE**