

BENCH HIGH BASE CABINET WL-2412

Teclab builds modular cabinetry of superior strength, thanks to twin full-perimeter frames. We also set door and drawer faces into the cabinet shell to protect the contents from spills.



WL-2412 FEATURES

One "A" drawer, one "B" drawer, one "B" door with LH pull base cabinet.

Cabinet Dimensions: 24" wide, 35 1/2" high, 22" deep

"A" Drawer

Drawer Face Dimensions: 22 3/8" wide, 3 1/4" high, 1" thick.
 Drawer Body Inside Dimensions: 19 7/8" w, 2" h, 19 1/2" deep.
 Weight Capacity: 75 lbs.

"B" Drawer

Drawer Face Dimensions: 22 3/8" wide, 6 1/16" high, 1" thick.
 Drawer Body Inside Dimensions: 19 7/8" w, 5" h, 19 1/2" deep.
 Weight Capacity: 75 lbs.

"B" Door with Left Hand Pull

Door Face Dimensions: 22 3/8" wide, 16 1/16" high, 1" thick

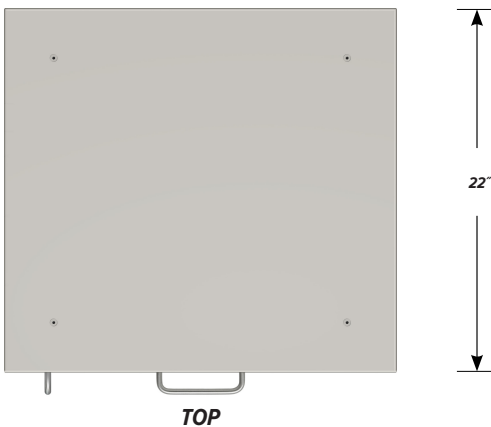

TOP



FRONT

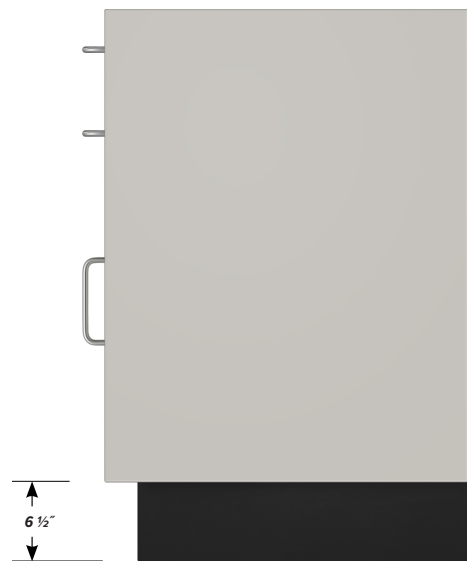

SIDE

