

BENCH HIGH SINK CABINET WL-2409

Teclab builds modular cabinetry of superior strength, thanks to twin full-perimeter frames. We also set door and drawer faces into the cabinet shell to protect the contents from spills.

WL-2409 FEATURES

One "B" panel, one "C" door with LH pull base cabinet.

Cabinet Dimensions: 24" wide, 35 1/2" high, 22" deep

"B" Panel

Dimensions: 22 3/8" wide, 6 1/16" high, 1" thick.

"C" Door with Left Hand Pull

Door Face Dimensions: 22 3/8" wide, 20 3/8" high, 1" thick.

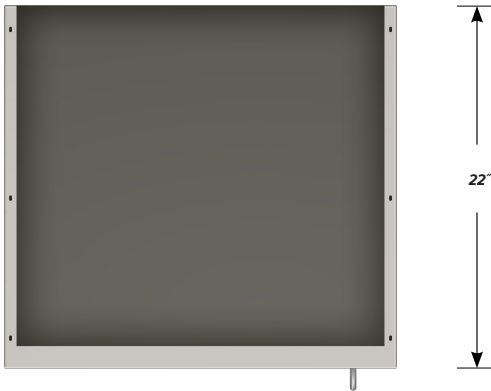

TOP

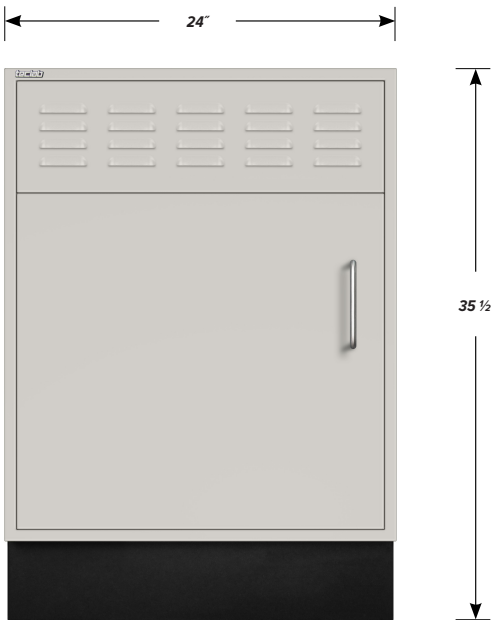

FRONT

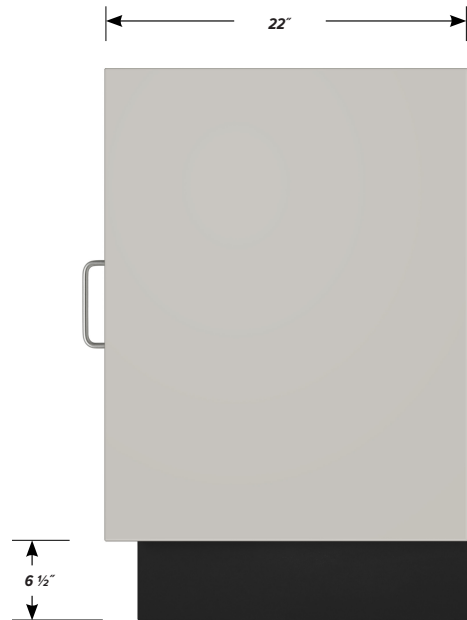

SIDE