

BENCH HIGH BASE CABINET WL-1805

Teclab builds modular cabinetry of superior strength, thanks to twin full-perimeter frames. We also set door and drawer faces into the cabinet shell to protect the contents from spills.



WL-1805 FEATURES

Two "A" drawer, One "C" door with RH pull base cabinet.

Cabinet Dimensions: 18" wide, 35 1/2" high, 22" deep

"A" Drawer

Drawer Face Dimensions: 16 3/8" wide, 3 1/4" high, 1" thick.
 Drawer Body Inside Dims.: 13 7/8" wide, 2" high, 19 1/2" deep.
 Weight Capacity: 75 lbs.

"C" Door with Right Hand Pull

Door Face Dimensions: 16 3/8" wide, 20 3/8" high, 1" thick.

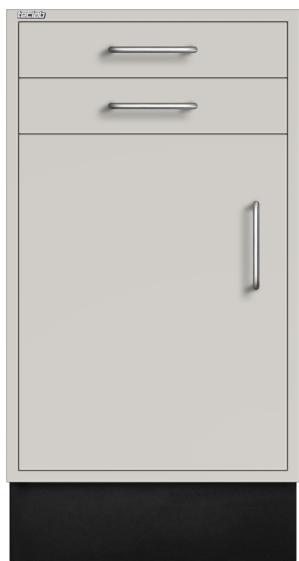

FRONT

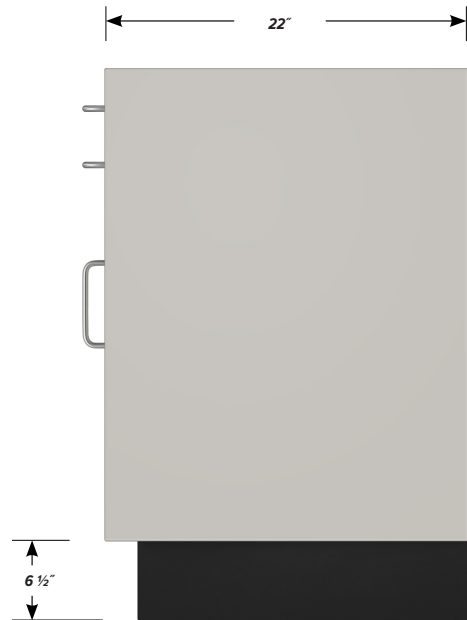

SIDE