

**BENCH HIGH BASE CABINET WL-1803**

Teclab builds modular cabinetry of superior strength, thanks to twin full-perimeter frames. We also set door and drawer faces into the cabinet shell to protect the contents from spills.



**WL-1803 FEATURES**

**One "B" drawer, One "C" door with RH pull base cabinet.**

Cabinet Dimensions: 18" wide, 35 1/2" high, 22" deep

**"B" Drawer**

Drawer Face Dimensions: 16 3/8" wide, 6 1/4" high, 1" thick.  
 Drawer Body Inside Dims.: 13 7/8" wide, 5" high, 19 1/2" deep.  
 Weight Capacity: 75 lbs.

**"C" Door with Right Hand Pull**

Door Face Dimensions: 16 3/8" wide, 20 3/8" high, 1" thick.

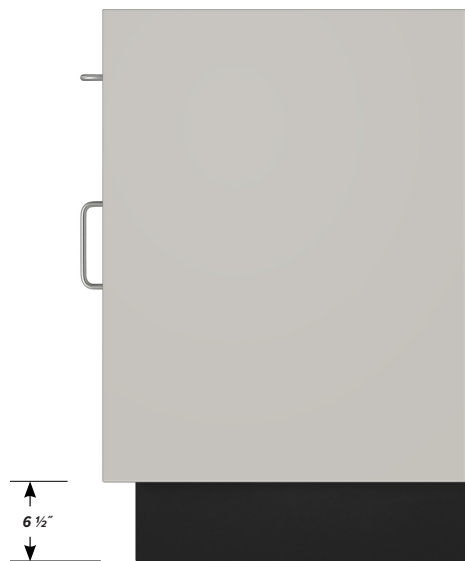
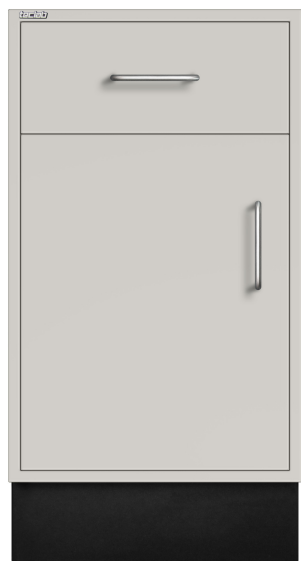
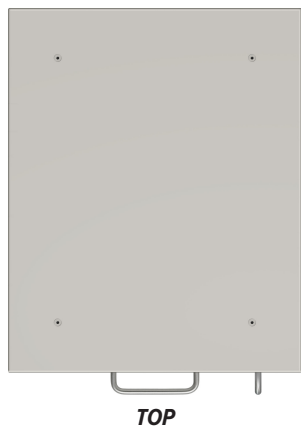

**FRONT**

**SIDE**