

**DESK HIGH BASE CABINET DL-3603**

Teclab builds modular cabinetry of superior strength, thanks to twin full-perimeter frames. We also set door and drawer faces into the cabinet shell to protect the contents from spills.



**DL-3603 FEATURES**

**One "B" drawer, two "A" door base cabinet.**

Cabinet Dimensions: 36" wide, 28" high, 22" deep

**"B" Drawer**

Drawer Face Dimensions: 34 3/8" w, 6 1/16" h, 1" thick.  
 Drawer Body Inside Dims.: 31 7/8" w, 5" h, 19 1/2" deep.  
 Weight Capacity: 75lbs.

**"A" Door**

Door Face Dimensions: 17 1/4" wide, 13 1/2" high, 1" thick.



**TOP**



**FRONT**

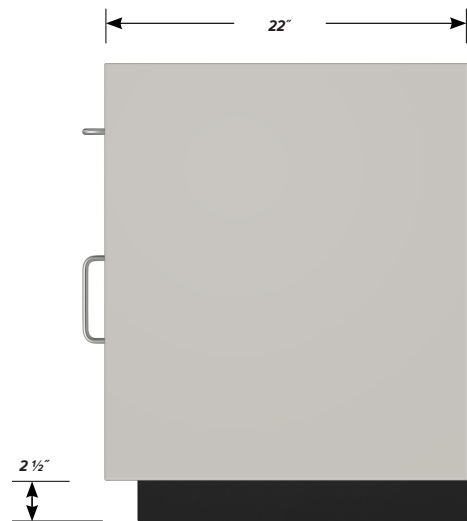

**SIDE**