

DESK HIGH BASE CABINET DL-2418

Teclab builds modular cabinetry of superior strength, thanks to twin full-perimeter frames. We also set door and drawer faces into the cabinet shell to protect the contents from spills.

Any Base Cabinet can be made **MOBILE**.

Height of a Desk High cabinet will increase by 3".



DL-2418 FEATURES

One "B" panel, one "A" door with RH pull sink cabinet.

Cabinet Dimensions: 24" wide, 28" high, 22" deep

"B" Panel

Dimensions: 22 ³/₈" wide, 6 ¹¹/₁₆" high, 1" thick.

"A" Door with Right Hand Pull

Door Face Dimensions: 22 ³/₈" wide, 13 ¹/₂" high, 1" thick.

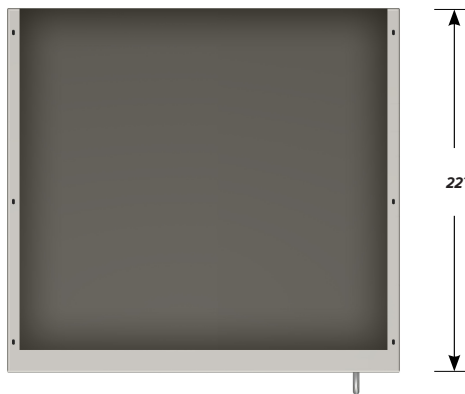

TOP

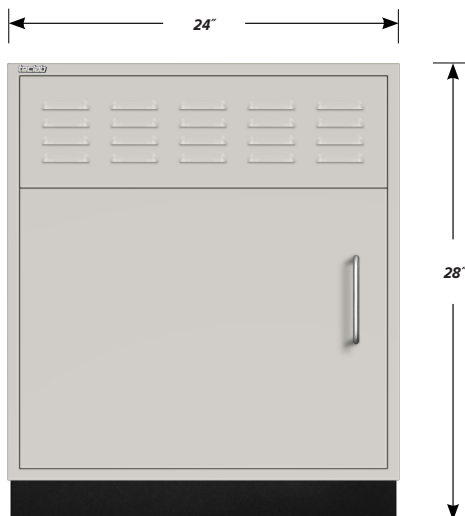

FRONT

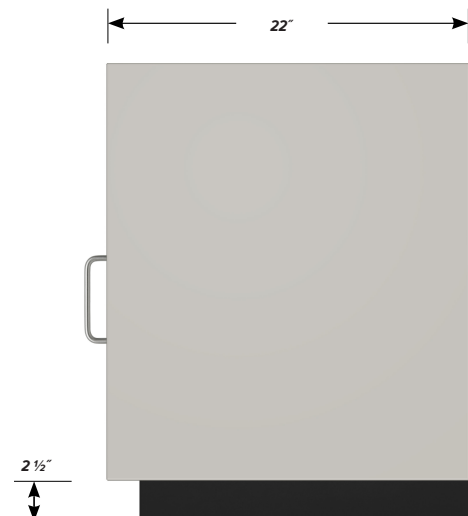

SIDE