

DESK HIGH BASE CABINET DL-2403

Teclab builds modular cabinetry of superior strength, thanks to twin full-perimeter frames. We also set door and drawer faces into the cabinet shell to protect the contents from spills.



DL-2403 FEATURES

One "A" drawer, one "C" door with RH pull base cabinet.

Cabinet Dimensions: 24" wide, 28" high, 22" deep

"A" Drawer

Drawer Face Dimensions: 22 3/8" wide, 3 1/4" high, 1" thick.
 Drawer Body Inside Dims.: 19 7/8" wide, 2" high, 19 1/2" deep.
 Weight Capacity: 75 lbs.

Top "A" drawer can be replaced with a writing surface.

"C" Door with Right Hand Pull

Door Face Dimensions: 22 3/8" wide, 20 3/8" high, 1" thick.

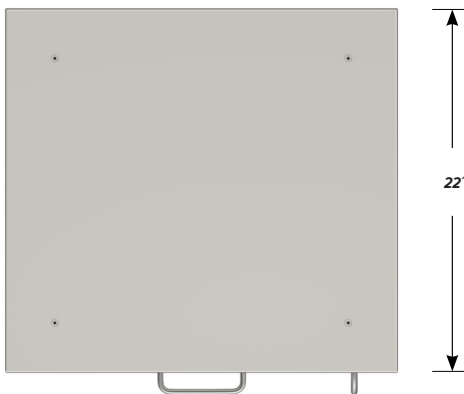

TOP

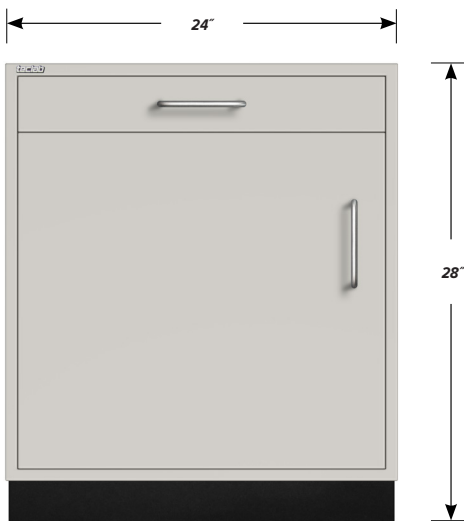

FRONT

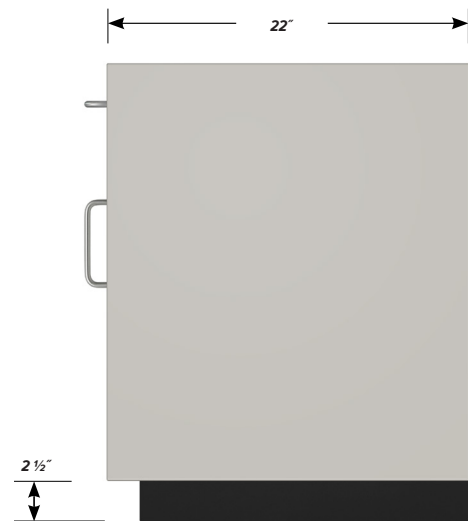

SIDE