

## DESK HIGH BASE CABINET DL-1812

Teclab builds modular cabinetry of superior strength, thanks to twin full-perimeter frames. We also set door and drawer faces into the cabinet shell to protect the contents from spills.

Any Base Cabinet can be made **MOBILE**.

Height of a Desk High cabinet will increase by 3".



### DL-1812 FEATURES

**Three "A" drawer, two "B" drawer base cabinet.**

Cabinet Dimensions: 18" wide, 28" high, 22" deep

#### "A" Drawer

Drawer Face Dimensions: 16  $\frac{3}{8}$ " wide, 3  $\frac{1}{4}$ " high, 1" thick.

Drawer Body Inside Dims.: 13  $\frac{7}{8}$ " wide, 2" high, 19  $\frac{1}{2}$ " deep.

Weight Capacity: 75 lbs.

*Top "A" drawer can be replaced with a writing surface.*

#### "B" Drawer

Drawer Face Dimensions: 16  $\frac{3}{8}$ " wide, 6  $\frac{1}{16}$ " high, 1" thick.

Drawer Body Inside Dims.: 13  $\frac{7}{8}$ " wide, 5" high, 19  $\frac{1}{2}$ " deep.

Weight Capacity: 75 lbs.

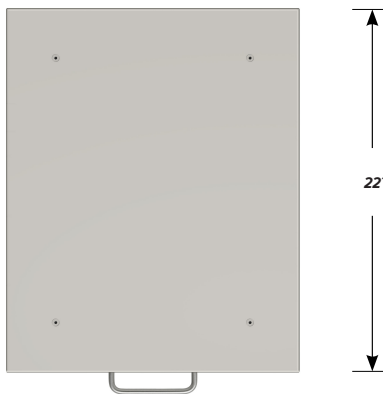

**TOP**

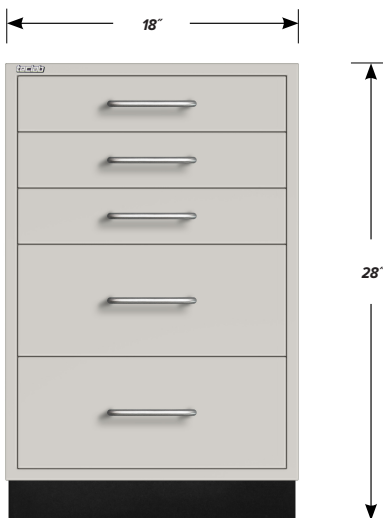

**FRONT**

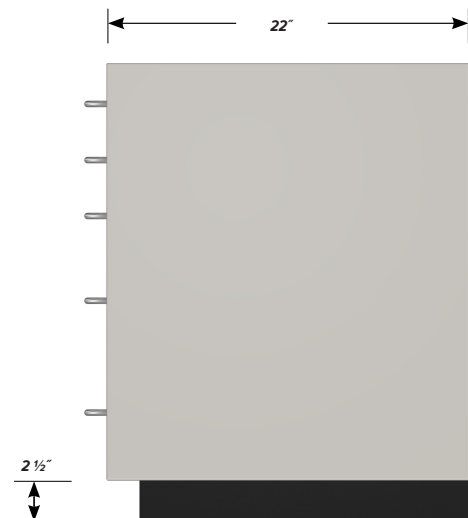

**SIDE**