

## DESK HIGH BASE CABINET DL-1809

Teclab builds modular cabinetry of superior strength, thanks to twin full-perimeter frames. We also set door and drawer faces into the cabinet shell to protect the contents from spills.

Any Base Cabinet can be made **MOBILE**.

Height of a Desk High cabinet will increase by 3".



### DL-1809 FEATURES

#### Two "E" drawer base cabinet.

Cabinet Dimensions: 18" wide, 28" high, 22" deep

#### "E" Drawer

Drawer Face Dimensions: 16  $\frac{3}{8}$ " wide, 11  $\frac{13}{16}$ " high, 1" thick.  
Drawer Body Inside Dims.: 13  $\frac{7}{8}$ " wide, 9  $\frac{1}{2}$ " high, 19  $\frac{1}{2}$ " deep.  
Weight Capacity: 75 lbs.

*All "E" drawers accept standard hanging files with the addition of our Hanging File Adapter Kit.*

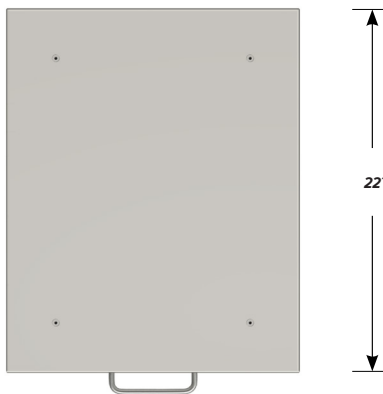

**TOP**

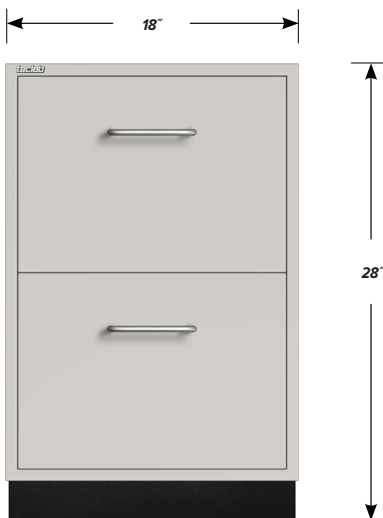

**FRONT**

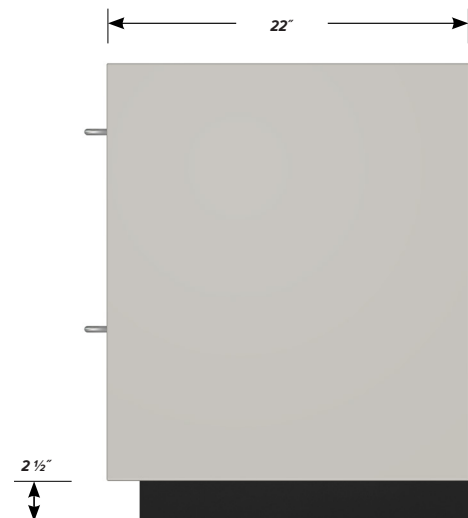

**SIDE**