

DESK HIGH BASE CABINET DL-1806

Teclab builds modular cabinetry of superior strength, thanks to twin full-perimeter frames. We also set door and drawer faces into the cabinet shell to protect the contents from spills.



DL-1806 FEATURES

One "B" drawer, one "A" door with LH pull base cabinet.

Cabinet Dimensions: 18" wide, 28" high, 22" deep

"B" Drawer

Drawer Face Dimensions: 16 3/8" wide, 6 1/4" high, 1" thick.
 Drawer Body Inside Dims.: 13 7/8" wide, 5" high, 19 1/2" deep.
 Weight Capacity: 75 lbs.

"A" Door with Left Hand Pull

Door Face Dimensions: 16 3/8" wide, 13 1/2" high, 1" thick.

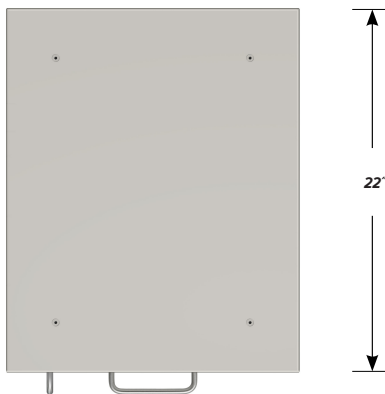

TOP

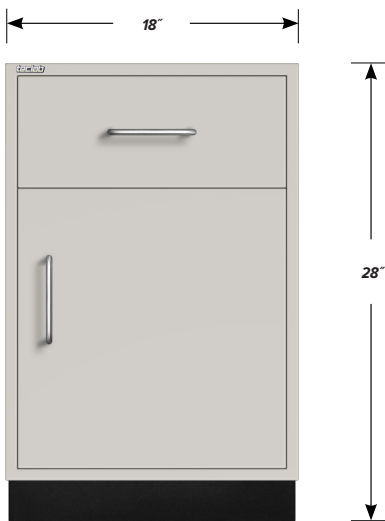

FRONT

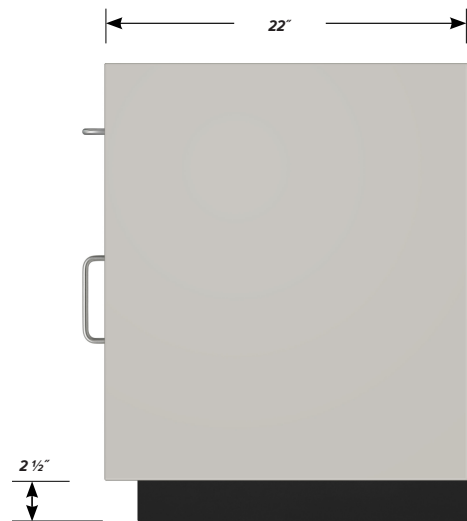

SIDE