

DESK HIGH BASE CABINET DL-1805

Teclab builds modular cabinetry of superior strength, thanks to twin full-perimeter frames. We also set door and drawer faces into the cabinet shell to protect the contents from spills.

Any Base Cabinet can be made **MOBILE**.

Height of a Desk High cabinet will increase by 3".



DL-1805 FEATURES

One "B" drawer, one "A" door with RH pull base cabinet.

Cabinet Dimensions: 18" wide, 28" high, 22" deep

"B" Drawer

Drawer Face Dimensions: 16 $\frac{3}{8}$ " wide, 6 $\frac{1}{16}$ " high, 1" thick.
Drawer Body Inside Dims.: 13 $\frac{7}{8}$ " wide, 5" high, 19 $\frac{1}{2}$ " deep.
Weight Capacity: 75 lbs.

"A" Door with Right Hand Pull

Door Face Dimensions: 16 $\frac{3}{8}$ " wide, 13 $\frac{1}{2}$ " high, 1" thick.

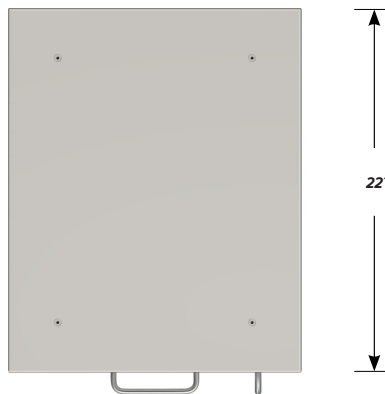

TOP

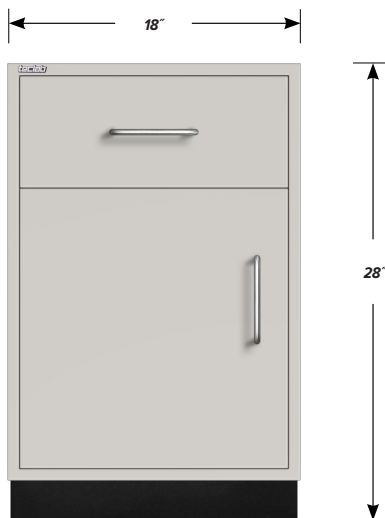

FRONT

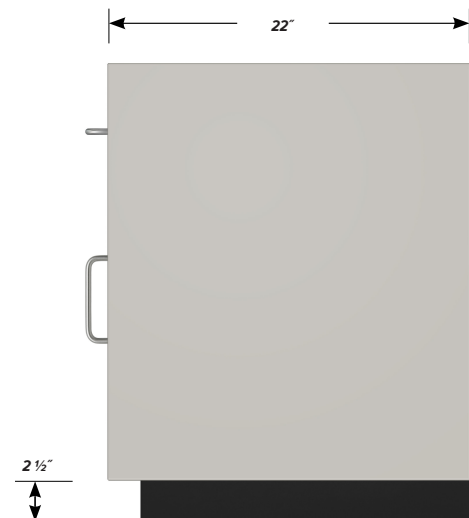

SIDE